

Lot 7 .87 Ac.

Riverbend Forest

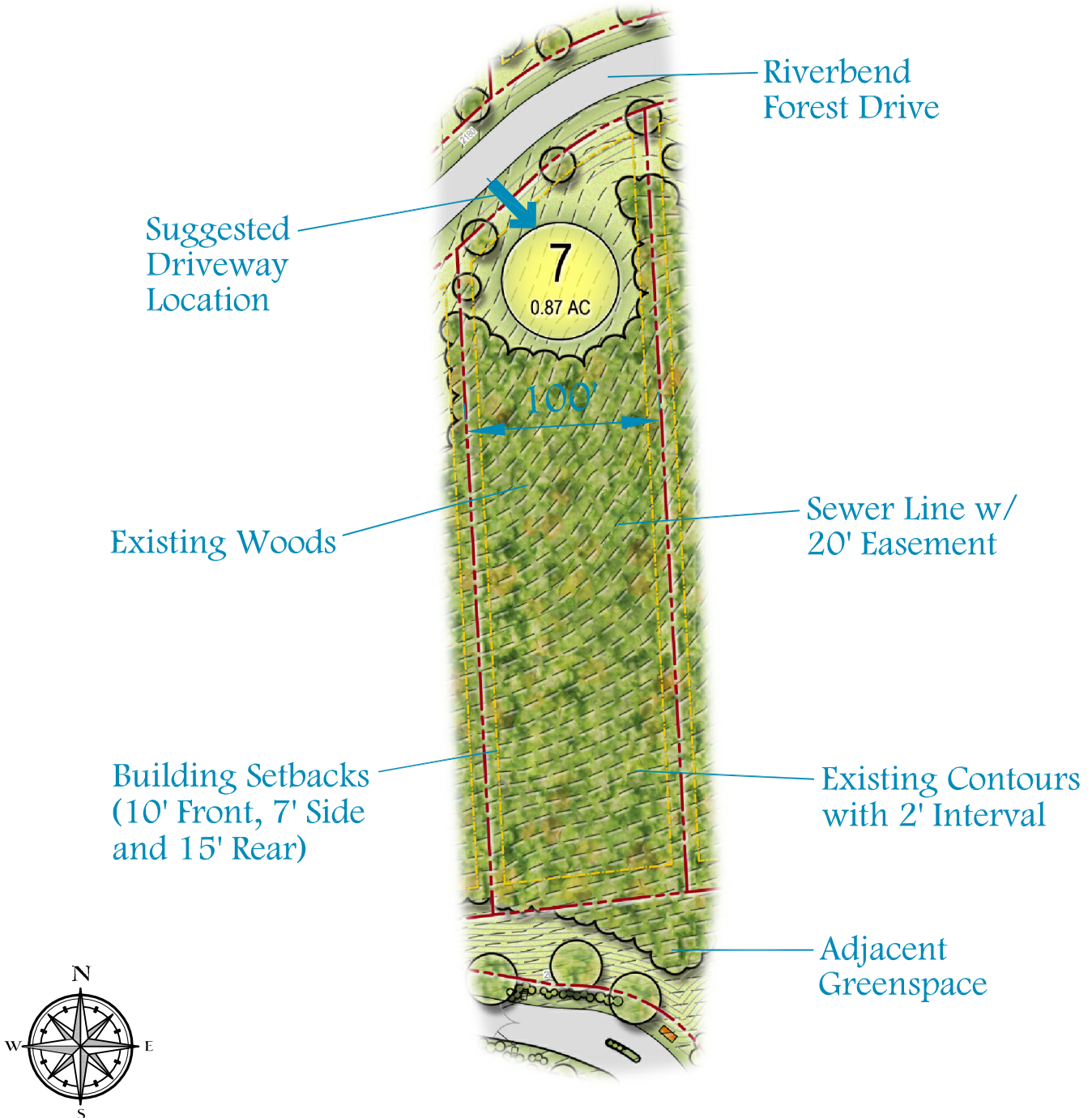

155 Riverbend Forest Drive
Asheville, NC 28805

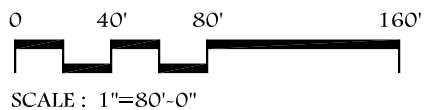

© 2020 RBF Development, LLC. Setbacks shown on this plan are as established by Buncombe County. Lot acreage and boundary lines are based on proposed plat. Final surveyed acreage and boundaries may vary. Utility/infrastructure elements shown are based on design drawings, not as-built surveys. Topography shown is taken from an aerial topographic map and engineering plans and is not the result of a field topographic survey. A field topographic survey and tree survey should be performed prior to any new construction.

